

## S-type load cell Model TTS



- Capacities from 100 to 5000 kg
- International industrial standard in dimensions and design
- Great weighing accuracy
- Ideal for all industries
- OIML R60
- 6-wire sense circuit
- IP68

The TEKFA S-type load cell, model TTS, is suitable for a broad range of purposes.

The TTS model can be used as a pressure as well as a tension load cell and is typically used in hanging scales, platform scales etc.

The load cells are constructed in stainless steel, and with the tightness degree IP68, they are protected against water and dust. The TTS load cells are manufactured in capacities from 100 to 5000 kg.

All TEKFA load cells have calibration certificates with exactly specified rated output and zero balance. This way, a load cell can be replaced by another of the same capacity, often with a very simple recalibration of the system.

The load cells can be connected to all 350Ω weighing amplifiers as well as TEKFA's instruments are ranging from simple weighing indicators to PLC and weighing computers with programs designed for the single customer.

## Specifications

Capacity	100-5000	kg
Rated output	2.0 ± 0.002	mV/V
Total error	±0.03	% F.S.
Linearity	±0.03	% F.S.
Zero balance	±1	% F.S.
Input impedance	400 ± 10	Ω
Output impedance	352 ± 2	Ω
Insulation impedance	≥5000	MΩ
Temperature range	-30 - +70	°C
Safe overload	150	% F.S.
Destructive overload	200	% F.S.
Recommended excitation	10-12	VDC/VAC
Maximum excitation	15	VDC/VAC
Material	TTS	Stainless steel
Protection	IP68	
Cable length	5	m
Own weight	500	g

## Connection

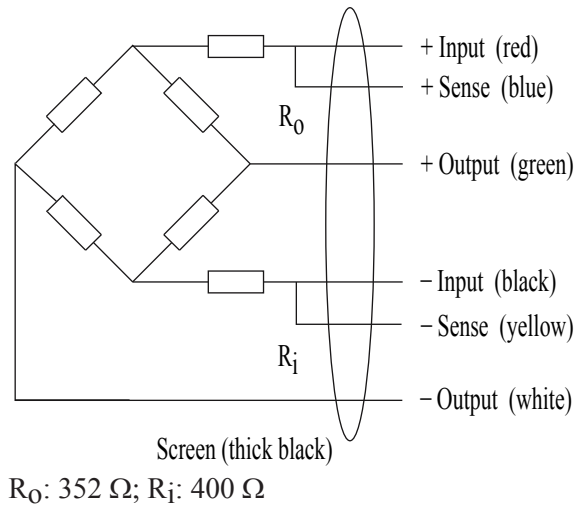

## Options

Extra cable

Mounts

Junction box

All dimensions in mm

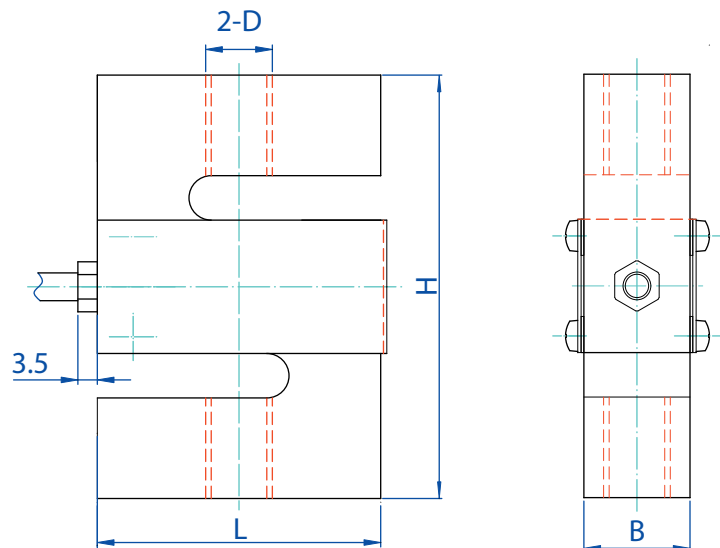

Cap. (kg)	D	L	H	B
100-500	M12	51.0	76.2	19.1
1000	M12	51.0	76.2	25.4
2000-5000	M20x1.5	76.2	100.4	31.8

Download drawings from TEKFA's homepage [www.tekfa.com/776/405](http://www.tekfa.com/776/405)

Type	Cap. (kg)	Type	Cap. (kg)	Type	Cap. (kg)	Type	Cap. (kg)	Type	Cap. (kg)
TTS	100	TTS	200	TTS	250	TTS	300	TTS	500
TTS	750	TTS	1000	TTS	2000	TTS	3000	TTS	5000